

TuBAR[®]/Turbine Retrofit for Wayne Ovation Receipt Door



GAS THEFT & SKIMMING!

TuBAR®/Turbine Receipt Door Retrofit: Ovation



Part # DWC-ORD-1

A. TuBAR®/Turbine Lock
(TuBAR shown)

B. Gasket

C. Cam Adapter

D. Cam

E. Cam Nut

F. Drill & Mounting
Template

G. Lock Washer

H. Cylinder Nut

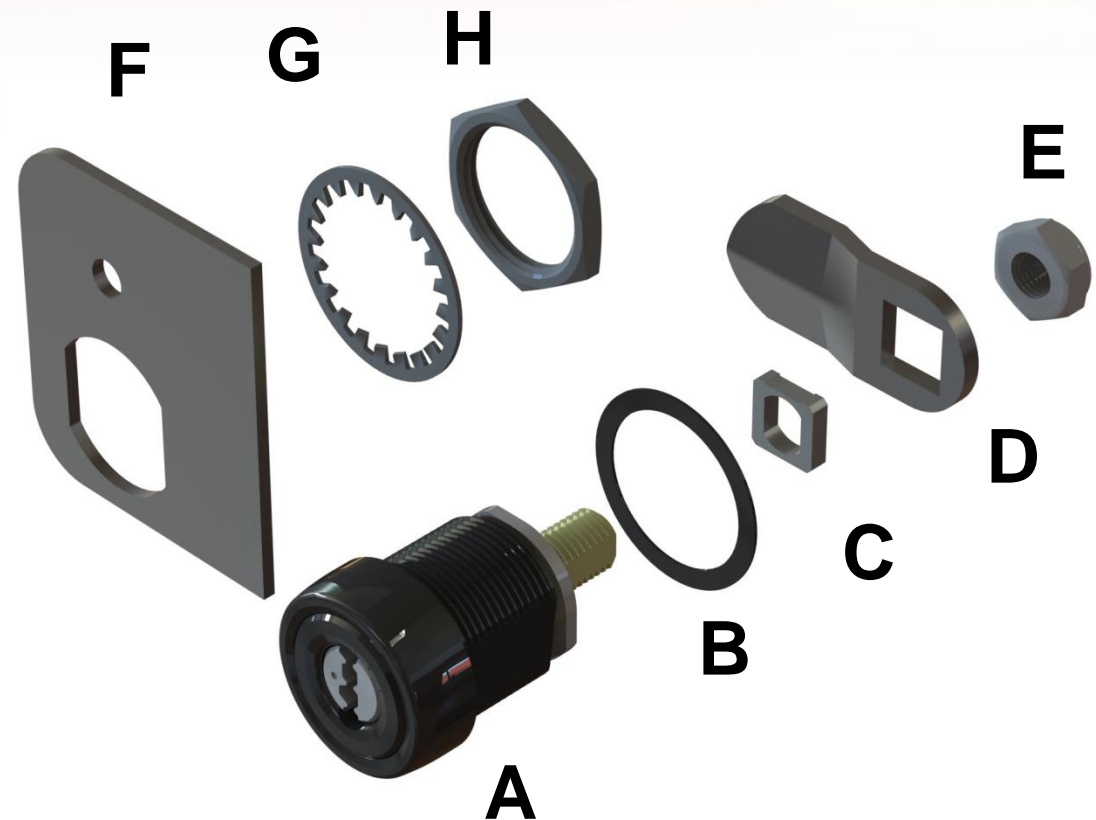

GAS THEFT & SKIMMING!

TuBAR[®]/Turbine Receipt Door Retrofit: Ovation Part # DWC-ORD-1



1. Use Drill Template (F) to drill $\text{Ø}3/16$ " pilot hole in Door by placing template in upper corner of receipt door interior. Align template against door frame with rounded corners positioned as shown.

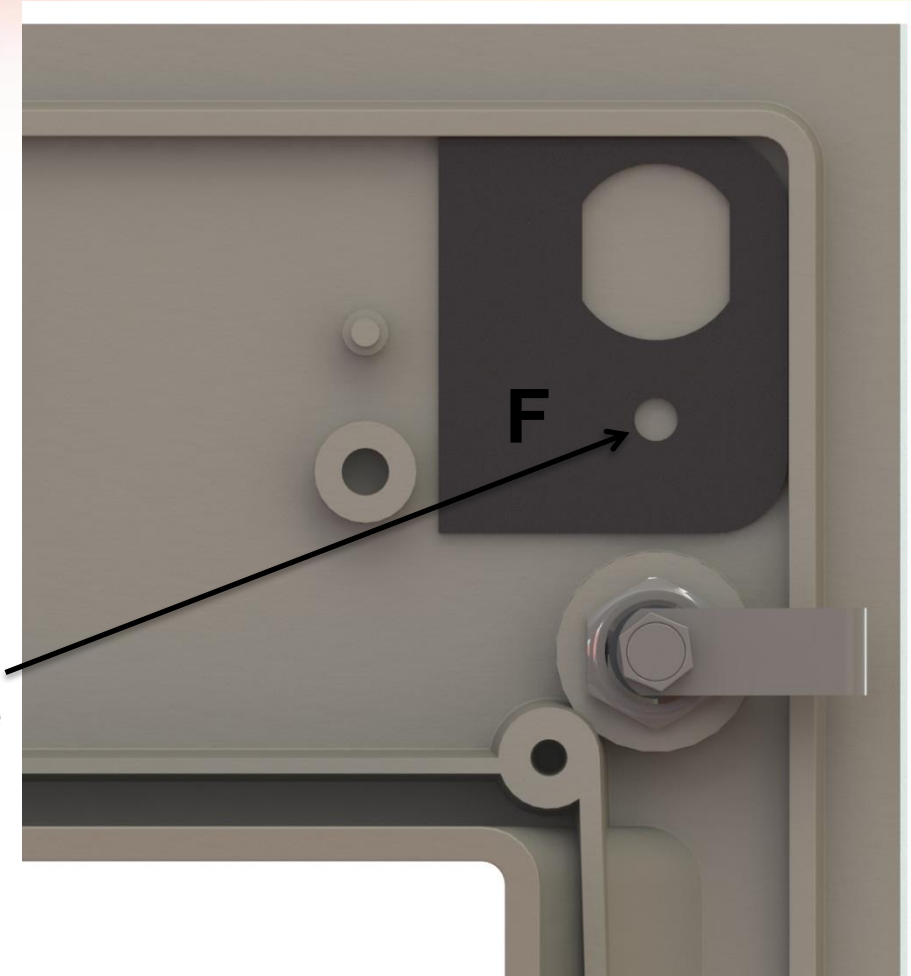

STOP GAS THEFT & SKIMMING!

TuBAR[®]/Turbine Receipt Door Retrofit: Ovation Part # DWC-ORD-1



2. Drill $\text{Ø}3/4$ " hole through pilot hole.

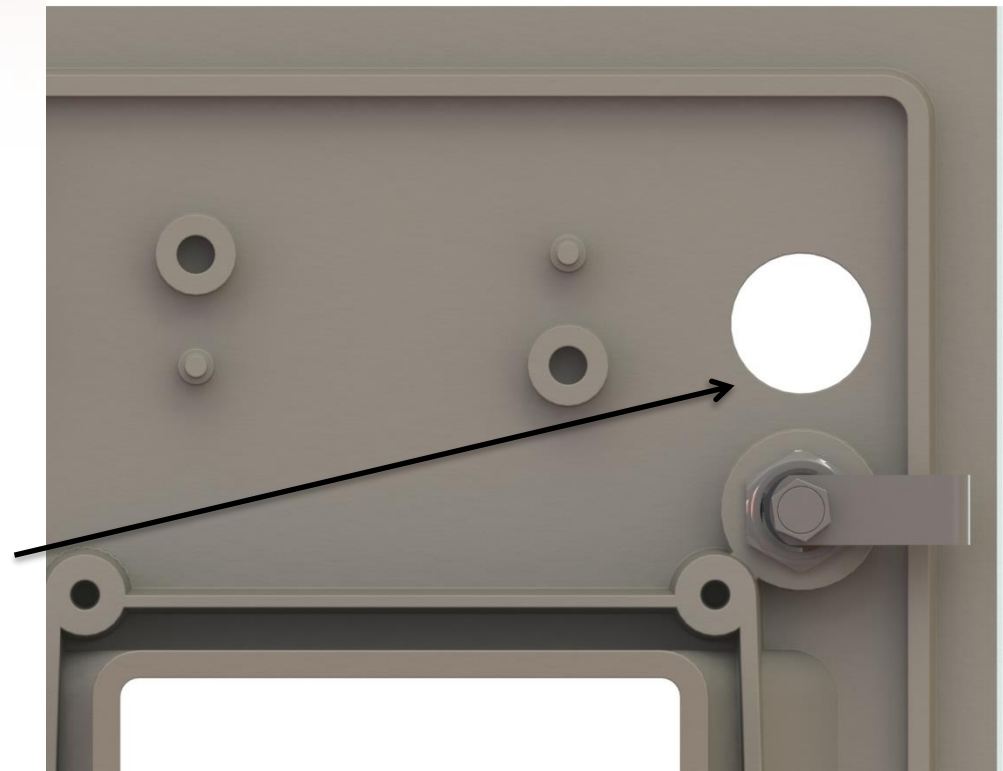

GAS THEFT & SKIMMING!

TuBAR[®]/Turbine Receipt Door Retrofit: Ovation Part # DWC-ORD-1

3. Install Lock A through Gasket B and into $\text{Ø}3/4$ hole in door. Orientation mark on lock face to left.

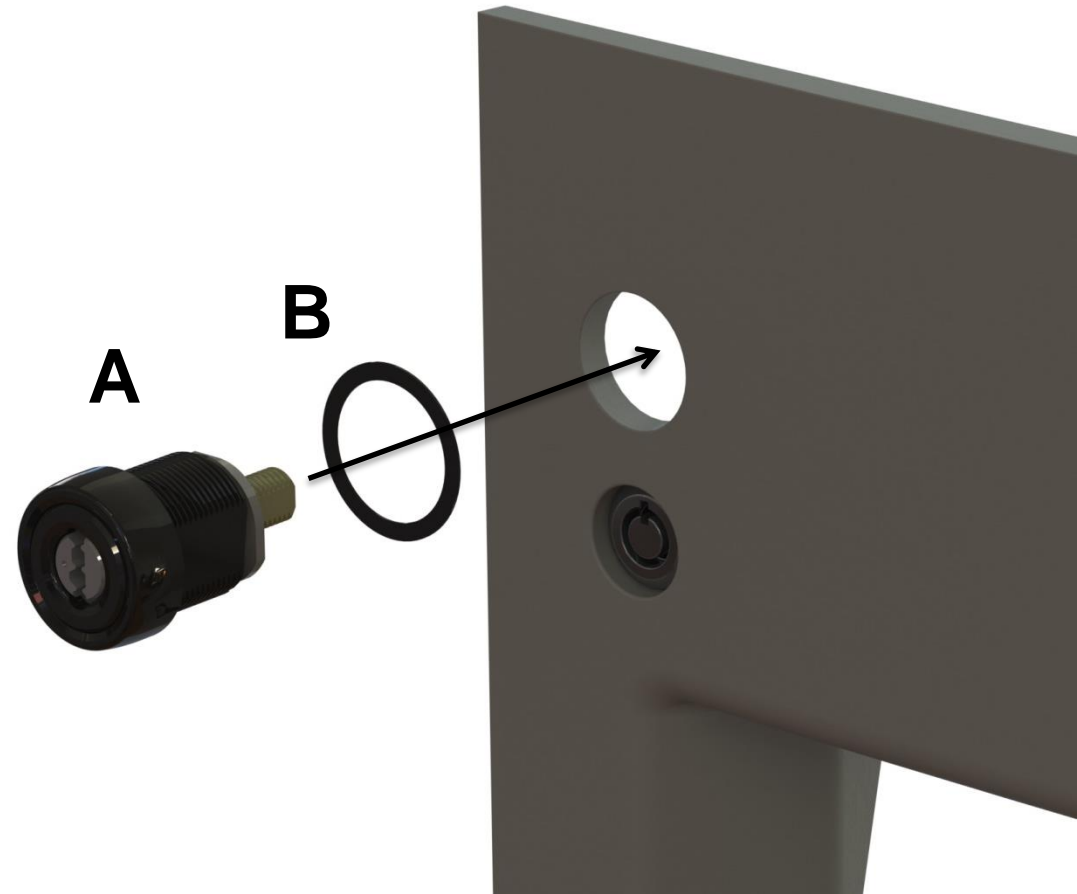

GAS THEFT & SKIMMING!

TuBAR[®]/Turbine Receipt Door Retrofit: Ovation Part # DWC-ORD-1



4. Install Mounting Plate F and Retaining Washer G over Lock and secure with Cylinder Nut H



Mounting Plate is required to prevent entire Lock from rotating

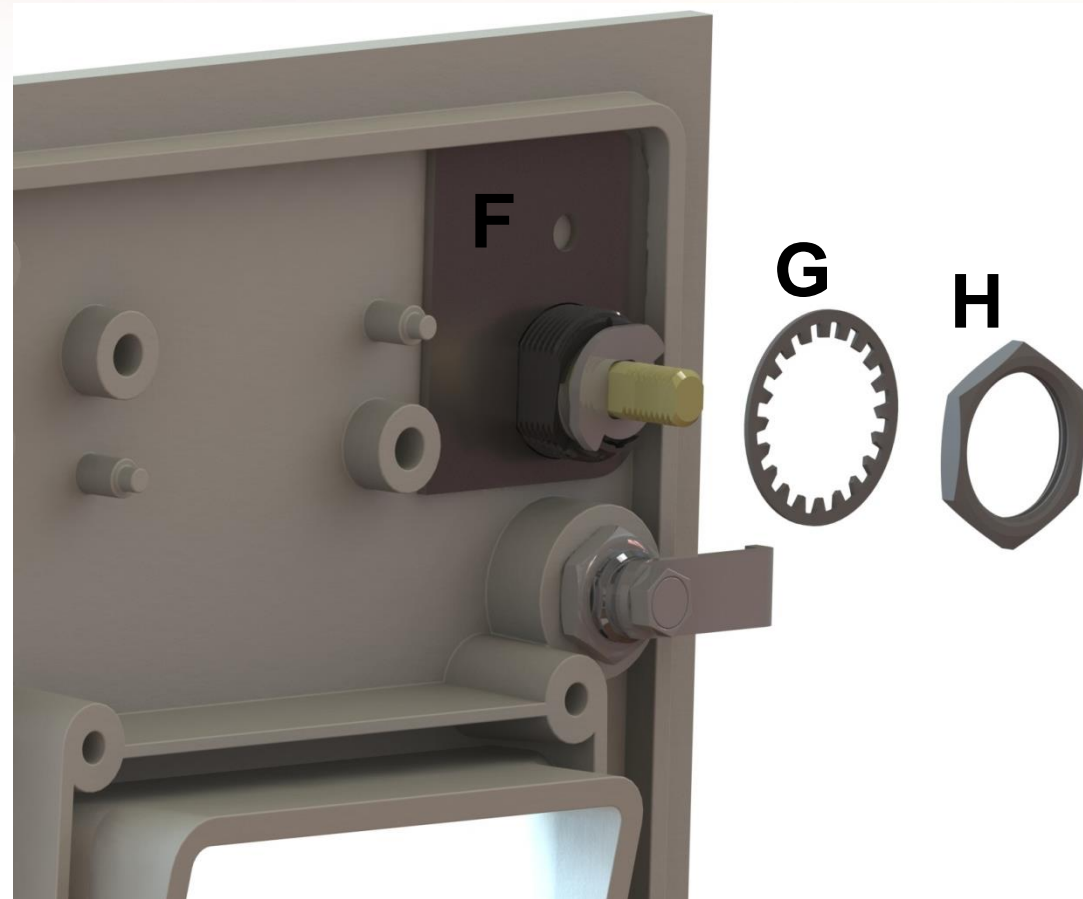

STOP GAS THEFT & SKIMMING!

TuBAR®/Turbine Receipt Door Retrofit: Ovation Part # DWC-ORD-1



5. Install Cam Adapter C, Cam D, and Cam Nut E on back of Lock

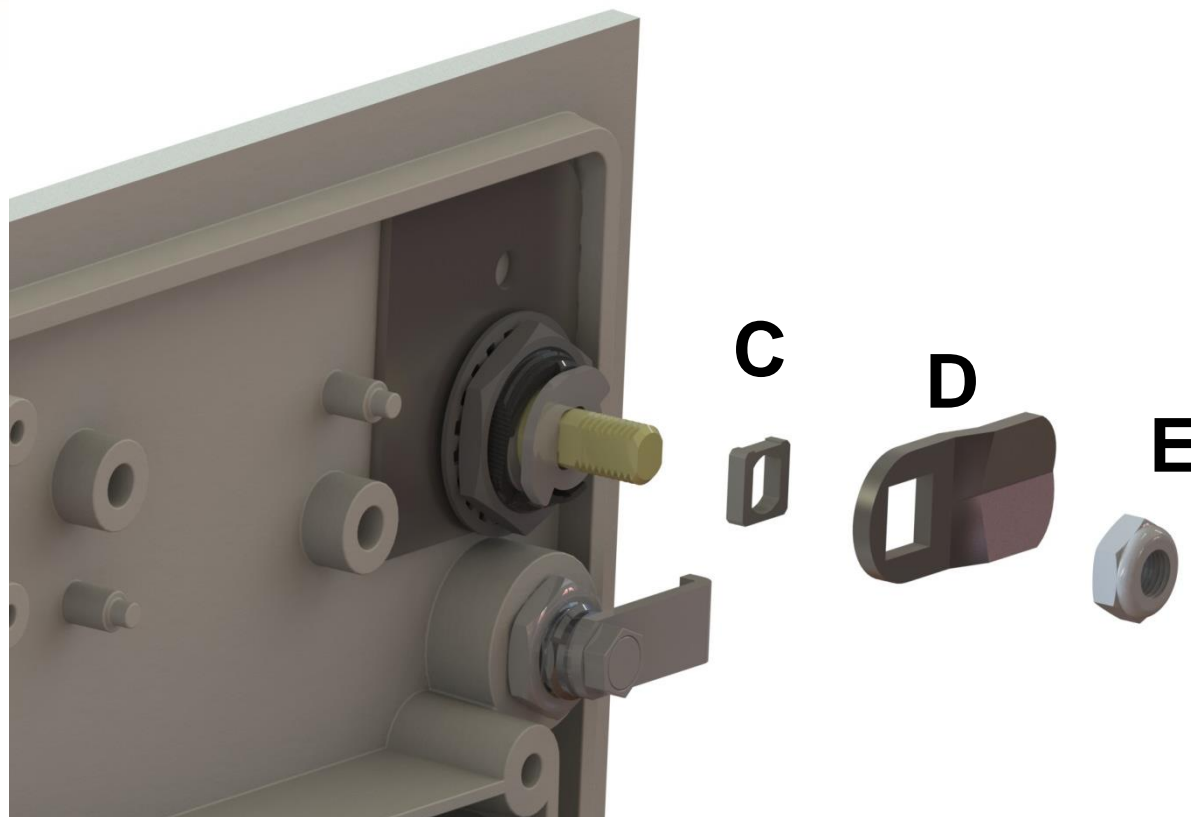

GAS THEFT & SKIMMING!

TuBAR®/Turbine Receipt Door Retrofit: Ovation Part # DWC-ORD-1



6. Optional – Remove or reposition cam on existing lock to disable. Leave lock in place to fill hole.

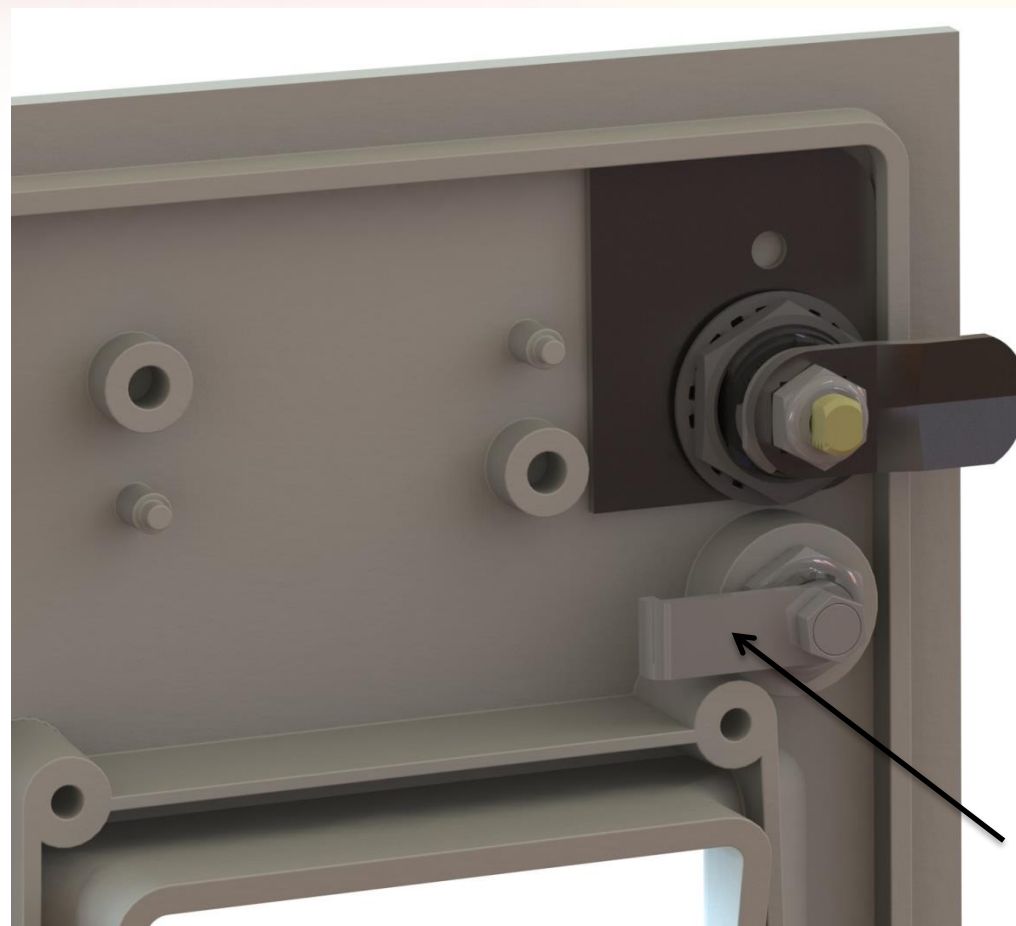

GAS THEFT & SKIMMING!