

Introducing **Puck Locks** from **CompX**

New! Puck Locks

Both Pucks are nickel plated and have hidden shackle pins, which make it hard to attack. The flat back and stepped back allow for use on various hasp designs. Check lock dimensions for the version that is best for your application.

- ◆ Puck locks with stepped and flat back have **hardened steel housings**
- ◆ Industry standard latching points (can create custom latching points)
- ◆ Uses CompX high security locks and non-duplicable keys
- ◆ Can match existing CompX key codes
- ◆ Used on various locking points including Pulser security boxes and skirt doors



*stepped
back, shown
with Turbine*



*flat back,
shown
with TuBAR*

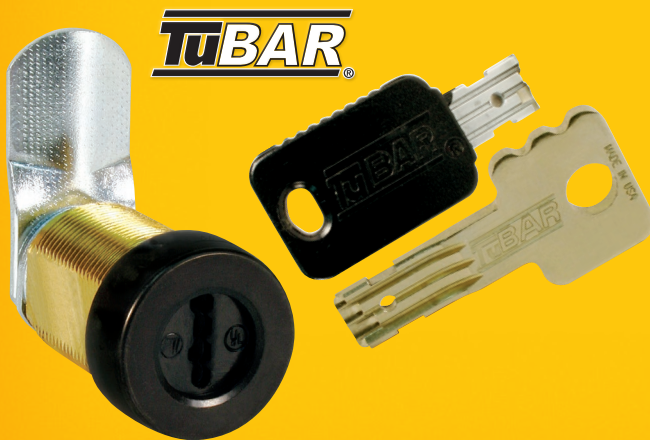

TuBAR



**NEW!
TURBINE**

CompX
SECURITY PRODUCTS

Crafting quality products
in America since 1903.

For more information, call **864.297.6655** or visit compX.com

Copyright 2020 © CompX Security Products. Any companies and/or products referred to herein are marks or registered trademarks of their respective companies, owners and/or mark holders.

Introducing Puck Locks

Flat back

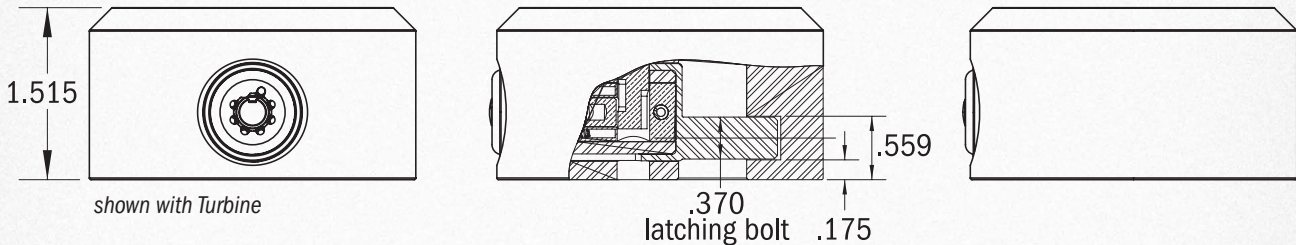

Flat back:				
Available with high security Turbine or highest security TuBAR locks and keys. Flat back configuration for flat surface mounted hasps*.				
Part number	Price	Quantity	Part number	Price
PL-FB-1 (TuBAR version)	\$116.47	1-9	PL-FB-2 (Turbine version)	\$113.28
	\$99.00	10-99		\$96.29
	\$81.52	100+		\$79.29

Stepped back

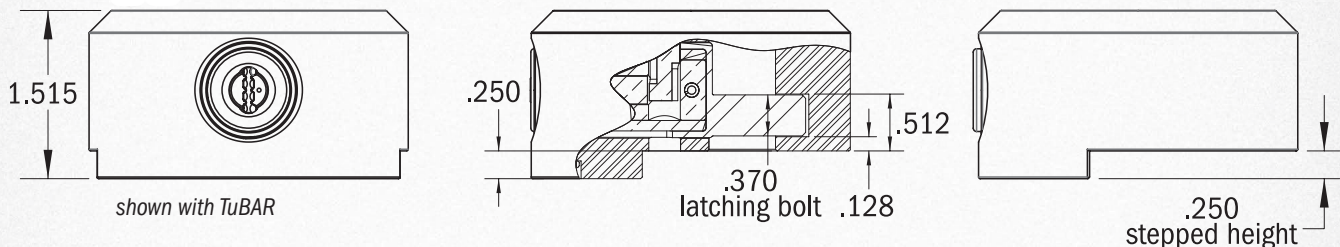

Stepped back:				
Available with high security Turbine or highest security TuBAR locks and keys. Stepped back configuration for stepped mounted hasps*.				
Part number	Price	Quantity	Part number	Price
PL-SB-1 (TuBAR version)	\$116.47	1-9	PL-SB-2 (Turbine version)	\$113.28
	\$99.00	10-99		\$96.29
	\$81.52	100+		\$79.29

* Confirm mounting hasp configuration and latching bolt location dimensions before purchase