

KEYPAD version

Pearl – installation instructions

Electronic push button cabinet lock

CompX Pearl

Thank you for purchasing the CompX® Pearl™. The Pearl is an innovative solution for locking cabinet doors and drawers. It can mount to cabinet doors or drawers with a material thickness of 1/32" to 1-7/16".

Powered by 2-AAAA batteries (included), Pearl operates using a 4 to 8 digit code. Operation is simple: type a valid code and press \Rightarrow (enter). Then just turn the knob to the unlocked or locked position.

Pearl is easy to install, and offers:

- ◆ Programmable user and supervisor codes
- ◆ Programmable modes of operation
- ◆ Programmable reset features

Pearl is intended for interior use only.

Operating Temperature: 50°F - 120°F
(10°C - 48°C)

Note:

It is strongly recommended that batteries be replaced on an annual basis. In the event the batteries are exhausted, they can be replaced via the external battery compartment.



Pearl – installation instructions

Electronic push button cabinet lock



Packaged Components

Contents – Manual Lock Version:

- 2 AAAA alkaline batteries
- 1 Offset locking cam / 1 Straight locking cam
- FlexaCam adapters
- Collar – Intended for surface mount applications
- Mounting hardware

Each lock is shipped with two green stickers that are needed for resetting Pearl. Place one of these green stickers on the back of the device, in case Pearl ever needs to be reset. The remaining green sticker should be saved in a safe and secure location for future reference. (See page 9 for reset instructions.)

The Pearl serial number can be found by sliding the housing base.

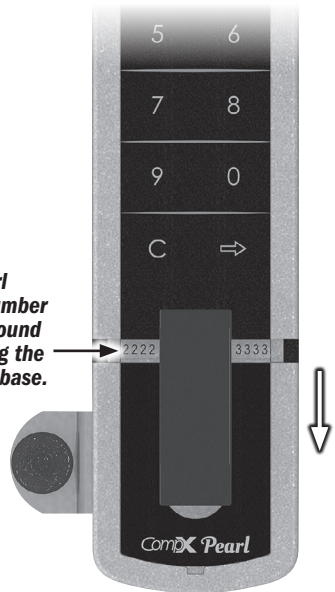

FlexaCam Adaptors

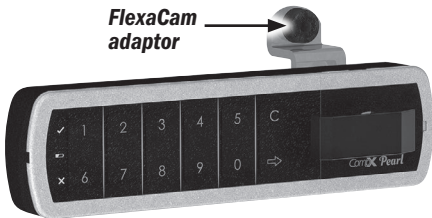

FlexaCam adaptors (if so equipped) can be attached to the cam to provide up to 12 different dimensional variations. See image to the left.

Care and Cleaning

To clean the Pearl surface, apply non-acid based cleaner to a clean cotton cloth; do not spray cleaner directly on

the Pearl. Wipe down keypad and its respective housing surfaces of excess cleaner.

Pearl – installation instructions

Electronic push button cabinet lock

CompX Pearl

Powering Up and Battery Installation

Pearl is shipped with two AAAA batteries. While Pearl features a low battery indicator, annual battery replacement is recommended. Mixing batteries of different chemistries or age could damage the Pearl resulting in lock failure.

To power up Pearl, remove the red tag. Lock is now ready for use.

Pearl batteries can be changed when locked or unlocked. A small tool, like a paper clip or eyeglass screwdriver, will be required to open the battery cover. (Not Included)

To change batteries:

1. Slide down housing base, see figure 1.
2. Release housing flip up by pressing housing latch, tool required, see figure 2 & 3.
3. Remove the two AAAA batteries and install the new batteries.
4. Close housing flip up and move housing base to the closed position, see figure 3.

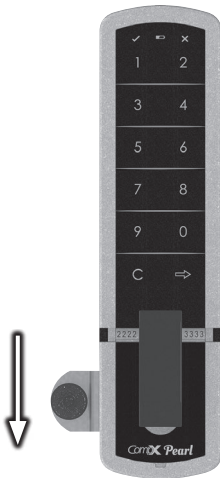

Figure 1



Figure 2
Housing Latch

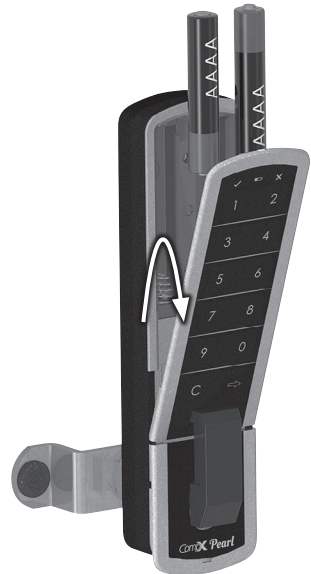

Figure 3

Batteries must be installed correctly for lock to function. Make note of correct battery installation before removing the old batteries.

Pearl – installation instructions

Electronic push button cabinet lock



Programming – Introduction

Pearl is easy to program and operate. Type the user code (factory default **1234**) and press \Rightarrow (enter) to unlock or lock the cabinet.

complete programming instructions prior to making any changes. Remember to keep track of any programming changes.

The supervisor can change operating codes, modes and restore lock settings. While Pearl is easy to program, we highly recommend reading the

Button locations, indicator lights and knob referenced in the programming instructions are shown below.

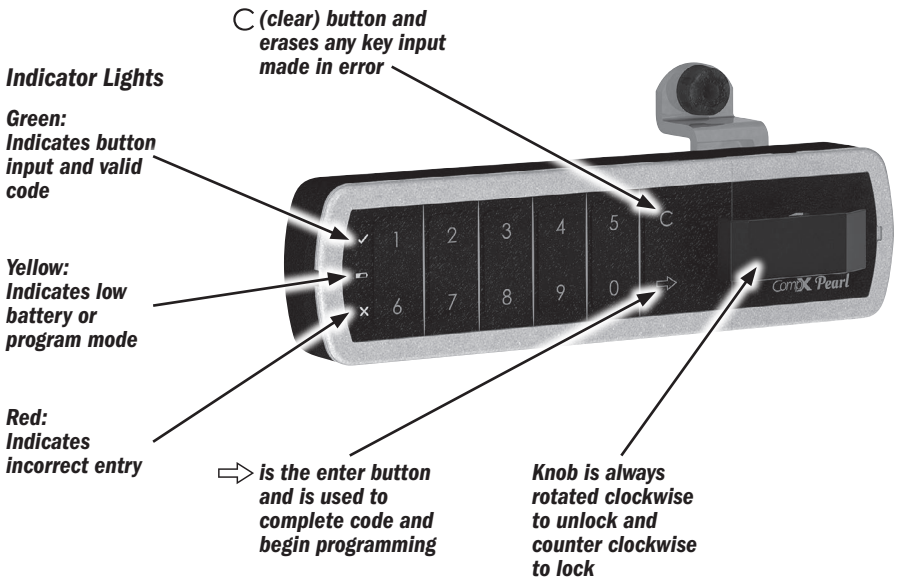

Pearl – installation instructions

Electronic push button cabinet lock



Programming – Introduction continued



Follow the directions below to unlock and lock the Pearl.

To operate the Pearl:

To **unlock**, type a valid code, press \Rightarrow (enter) and rotate knob clockwise 90°

To **lock**, rotate knob 90° counter clockwise.

Pearl Programming Mode

To enter programming mode you must know the supervisor code. The default supervisor code is **12345**. Once in programming mode, multiple changes can be made prior to exiting programming.

There is a **10** second programming time limit between each step. If Pearl times out or an error is made, programming will end and you will need to enter programming mode again.

1. Lock must be in the **locked** position prior to entering programming mode.
2. Type supervisor code and press \Rightarrow (enter).

Rotate the knob to the **unlocked** position and press and hold \Rightarrow (enter) for **3** seconds (**yellow** indicator light will illuminate).

3. With the **yellow** indicator light illuminated, programming can begin.

Pearl – installation instructions

Electronic push button cabinet lock



Changing the User Code

To change the user code, follow the steps on page 5 to enter programming mode.

The factory default user code is **1234** (User codes must be 4 to 8 digits in length.)

There is a **10** second programming time limit between each step. If Pearl times out or an error is made, programming will end and you will need to enter programming mode again.

1. Place Pearl into programming mode (see page 5).
2. Press **1** and then press \Rightarrow (enter).
3. Type the current user code and press \Rightarrow (enter).
4. Type the new user code and press \Rightarrow (enter).
5. Retype the new user code and press \Rightarrow (enter).
6. If successful, the **green** indicator light will illuminate for 1 second.

Continue programming or press **9** and then \Rightarrow (enter) to exit programming.

Changing the Supervisor Code

To change the supervisor code, follow the steps on page 5 to enter programming mode.

The factory default supervisor code is **12345** (supervisor codes must be 4 to 8 digits in length.)

There is a **10** second programming time limit between each step. If Pearl times out or an error is made, programming will end and you will need to enter programming mode again.

4. Type the new supervisor code and press \Rightarrow (enter).
5. Retype the new supervisor code and press \Rightarrow (enter).
6. If successful, the **green** indicator light will illuminate for **1** second.

Continue programming or press **9** and then \Rightarrow (enter) to exit programming.

Pearl features a reset code which will restore the default supervisor code and user code. Pearl was shipped with reset stickers – one should be attached to the back of the Pearl, and the extra sticker should be saved in a safe and secure location for future reference.

To restore the factory default supervisor and user code, type the Reset Code assigned to the Pearl and press \Rightarrow (enter).

1. Place Pearl into programming mode (see page 5).
2. Press **2** and then press \Rightarrow (enter).
3. Type the current supervisor code and press \Rightarrow (enter).

Pearl – installation instructions

Electronic push button cabinet lock



CompX Pearl features several modes of operation. These functions can be changed using the following instructions with a valid supervisor code.

Programming Single Use Mode / Standard Mode

Single Use Mode allows for a revolving user code so multiple people may use the lock without having to reprogram the Pearl each time.

Standard Mode operates with a fixed code. To change the code, follow the **Changing the User Code** steps on page 5.

To change the Pearl to Single Use or Standard Mode, follow the steps on page 5 to enter programming mode.

There is a **10** second programming time limit between each step. If Pearl times out or an error is made, programming will end and you will need to enter programming mode again.

1. Place Pearl into programming mode (see page 5).
 - a. To turn Single Use Mode “ON”: type **51** and then press \Rightarrow (enter).
OR
 - b. To return to Standard Mode: type **50** and then press \Rightarrow (enter).
2. If successful, the **green** indicator light will illuminate for 1 second.

Note: Returning to Standard Mode will reset the factory user default code (**1234**).

Continue programming or press **9** and then \Rightarrow (enter) to exit programming.

Pearl – installation instructions

Electronic push button cabinet lock



Programming Single Use Timeout ON / Single Use Timeout OFF

Warning: Manual Lock - Single Use Timeout ON is a feature to prevent users from occupying a shared use locker or cabinet for a prolonged period of time. Turning this feature on will disable the user code after a programmable amount of time. After this time elapses, Pearl can only be opened with the supervisor code.

To change the Pearl to Single Use Timeout ON or OFF, follow the steps on page 5 to enter programming mode.

There is a **10** second programming time limit between each step. If Pearl times out or an error is made, programming will end and you will need to enter programming mode again.

1. Place Pearl into programming mode (see page 5).

- a. To set Timeout ON, type **2XX** and then press \Rightarrow (enter).

(XX represents a time period from 04 to 48 in whole hours.)

OR

- b. To turn Timeout OFF, type **20** and then press \Rightarrow (enter).

3. If successful, the **green** indicator light will illuminate for 1 second.

Continue programming or press **9** and then \Rightarrow (enter) to exit programming.

Programming Security Timeout ON / Security Timeout OFF

Warning: Security Timeout ON will disable the Pearl from use for 5 minutes when 5 invalid attempts to unlock Pearl occur. During this time, Pearl will not unlock with either the valid user or supervisor code.

To change the Pearl to Security Timeout ON or OFF, follow the steps on page 5 to enter programming mode.

There is a **10** second programming time limit between each step. If Pearl times out or error is made, programming will end and you will need to enter programming mode again.

1. Place Pearl into programming mode see page 5).

- a. To turn **Security Timeout ON**, type **11** and then press \Rightarrow (enter).

OR

- b. To turn **Security Timeout OFF**, type **10** and then press \Rightarrow (enter).

2. If successful, the **green** indicator light will illuminate for 1 second.

Continue programming or press **9** and then \Rightarrow (enter) to exit programming.

Pearl – installation instructions

Electronic push button cabinet lock



Reset User Code to Factory Default 1234 *(Does not apply to Single Use Mode)*

To reset the **User Code** to the factory default **1234** follow the steps on page 5 to enter programming mode.

There is a **10** second programming time limit between each step. If Pearl times out or error is made, programming will end and you will need to enter programming mode again.

1. Place Pearl into programming mode (see page 5).
2. Type **8888** and then press the \Rightarrow (enter) button.
3. If successful, the **green** indicator light will illuminate for 1 second.

Continue programming or press **9** and then \Rightarrow (enter) to exit programming.

Add User Without Specifying Memory Slot

The **Supervisor Code** memory location is called **Slot 01** and the first **User Code** is called **Slot 02**.

Any additional User Codes reside in memory slots 03-20.

To add a user code without specifying a memory slot (03 -20), follow the steps on page 5 to enter programming mode.

User codes must be 4 to 8 digits in length and **must** be different from all existing codes (including Slot 01 Supervisor & Slot 02 User codes).

There is a **10** second programming time limit between each step. If Pearl times out or an error is made, programming will end and you will need to enter programming mode again.

1. Place Pearl into programming mode (see page 5).
2. Press **410** and then press \Rightarrow (enter).
3. Type the new user code and press \Rightarrow (enter)
4. Retype the new user code and press \Rightarrow (enter).
5. If successful, the **yellow** indicator light will illuminate.

Continue programming or press **9** and then \Rightarrow (enter) to exit programming.

Pearl – installation instructions

Electronic push button cabinet lock



Add User to Specific Memory Slot (03 – 20)

The **Supervisor code** memory location is called **Slot 01** and the first **User code** is called **Slot 02**.

Any additional user codes reside in memory slots 03-20.

To add a user code to a specific memory slot (03 -20), follow the steps on page 5 to enter programming mode.

User codes must be 4 to 8 digits in length and **must** be different from all existing codes (including Slot 01 Supervisor & Slot 02 User codes).

There is a **10** second programming time limit between each step. If Pearl times out or an error is made, programming will end and you will need to enter programming mode again.

1. Place Pearl into programming mode (see page 5).
2. Press **411**, then press \Rightarrow (enter).
3. Type memory slot to be added followed by \Rightarrow (enter) (for memory slots 03 - 09, you must type leading "0" – e.g. "07" for slot 7)
4. Retype memory slot to be added followed by \Rightarrow (enter)
5. Type the new user code and press \Rightarrow (enter).
6. Retype the new user code and press \Rightarrow (enter).
7. If successful, the **yellow** indicator light will illuminate.

Continue programming or press **9** and then \Rightarrow (enter) to exit programming.

Delete User Without Specifying Memory Slot

The **Supervisor code** memory location is called **Slot 01** and the first **User code** is called **Slot 02**.

The additional user codes reside in memory slots 03-20.

To delete a user code without specifying a memory slot (03 -20), follow the steps on page 5 to enter programming mode.

There is a **10** second programming time limit between each step. If Pearl times out or an error is made, programming will end and you will need to enter programming mode again.

1. Place Pearl into programming mode (see page 5).
2. Press **400** and then press \Rightarrow (enter).
3. Type the user code to be deleted and press \Rightarrow (enter).
4. Retype the user code to be deleted and press \Rightarrow (enter).
5. If successful, the **yellow** indicator light will illuminate.

Continue programming or press **9** and then \Rightarrow (enter) to exit programming.

Pearl – installation instructions

Electronic push button cabinet lock



Delete User From Specific Memory Slot (03 – 20)

The **Supervisor code** memory location is called **Slot 01** and the first **User code** is called **Slot 02**.

The additional user codes reside in memory slots 03-20.

To delete a user code from a specific memory slot (03 -20), follow the steps on page 5 to enter programming mode.

There is a **10** second programming time limit between each step. If Pearl times out or an error is made, programming will end and you will need to enter programming mode again.

1. Place Pearl into programming mode (see page 5).
2. Press **401**, then press \Rightarrow (enter).
3. Type memory slot to be vacated followed by \Rightarrow (enter) (for memory slots 03 - 09, you must type leading "0" – e.g. "07" for slot 7)
4. Retype memory slot to be vacated followed by \Rightarrow (enter).
5. If successful, the **yellow** indicator light will illuminate.

Continue programming or press **9** and then \Rightarrow (enter) to exit programming.

Display Number of Lock Operation

This feature shows the number of times the lock has been operated. The number of operations are displayed in yellow light blinks and separated by a green blink to determine the next value.

Example; yellow, yellow, yellow, green, yellow, yellow, green, yellow, green, yellow, green would equal 3211 lock operations.

There is a **10** second programming time limit between each step. If Pearl times out or an error is made, programming will end and you will need to enter programming mode again

4. Place Pearl into programming mode (see page 5).
 - a. To display number of lock operations Type **60** and then press \Rightarrow (enter).
OR
 - b. To reset to zero type **61** and then press \Rightarrow (enter).

Continue programming or press **9** and then \Rightarrow (enter) to exit programming.

Pearl – installation instructions

Electronic push button cabinet lock



Template for Surface Mounting

This template is for surface mounting. For flush mounting, please see Pearl mounting sheet online at:

<http://compX.com/downloads>

1"

WARNING: Print this page and measure the line above. It is **ONE INCH LONG**. If it measures less than or more than one inch, the template measurements also need to be scaled accordingly.

FAILURE TO DO SO COULD RESULT IN MISDRILLED HOLES.

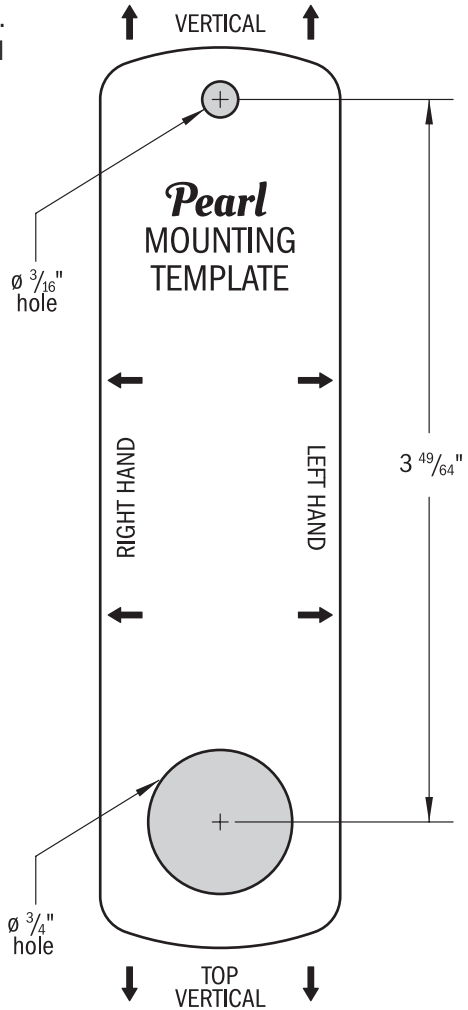

Part #: 334363000000

Copyright 2021 © CompX Security Products / 847.752.2600 / compXpearl.com / 715 Center St., Grayslake, IL 60030
Any companies and/or products referred to herein are marks or registered trademarks of their respective companies, owners and/or mark holders.