

LEFT HINGE DOOR

HORIZONTAL TOP MOUNT

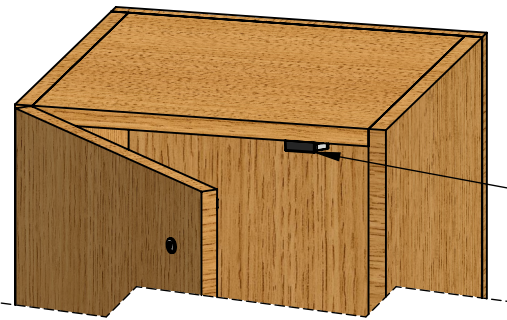

HORIZONTAL BOTTOM MOUNT

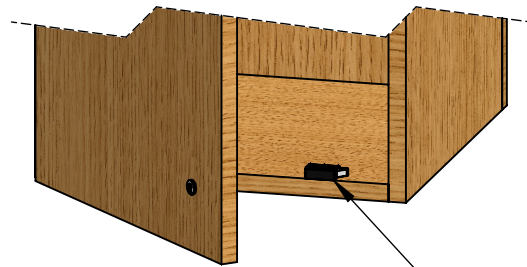

SST-100

RIGHT HINGE DOOR

HORIZONTAL TOP MOUNT

SST-100

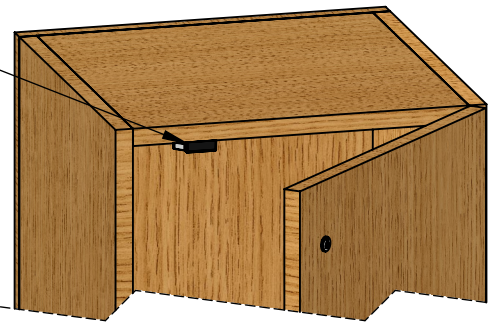

HORIZONTAL BOTTOM MOUNT

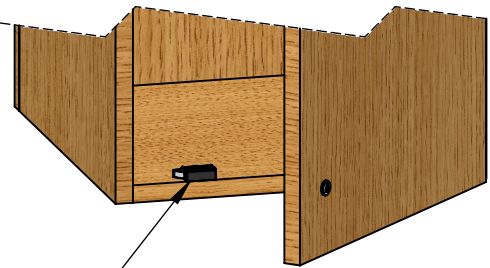

SST-200



VERTICAL MOUNT

SST-200

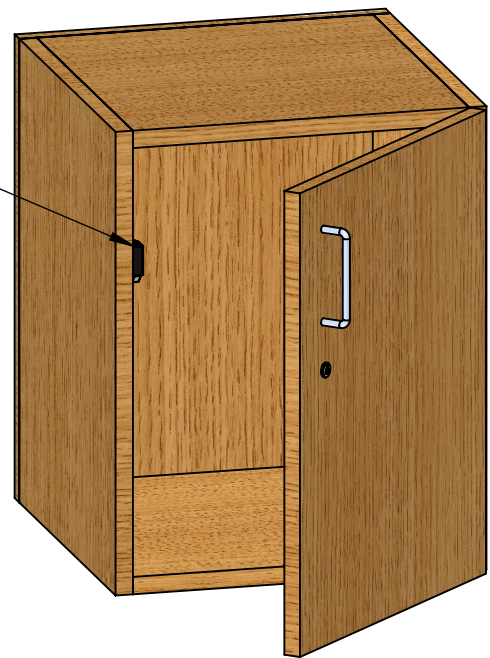

VERTICAL MOUNT

SST-100

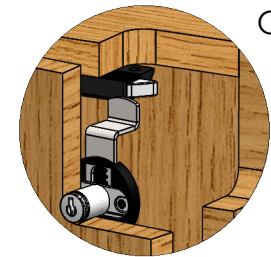

OPEN

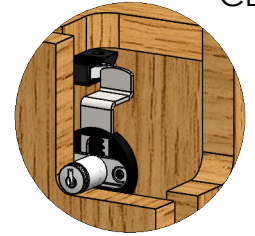

CLOSING

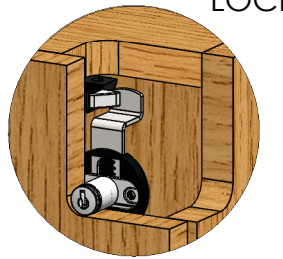

LOCKED

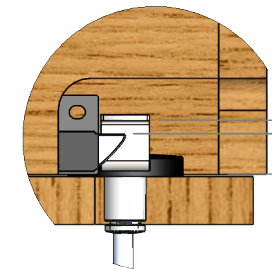

7/32 REF

REQUIRES MINIMUM SETBACK OF 23/32"

SST-200

SST-100

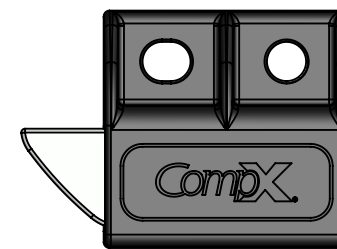

5/16 5/8 5/16

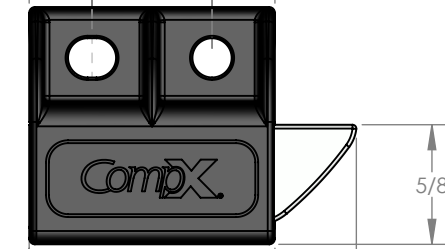

5/8

15/32 13/32

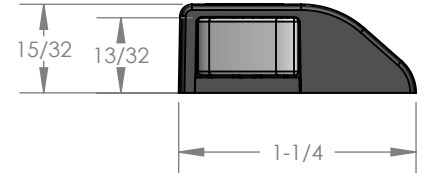

1-1/4

1-9/32 1-23/32

NOTES:

- BEST IF USED WITH COMPX TIMBERLINE:
DEADBOLT CYLINDER BODIES: CB-235 & CB-245
CAM LOCKS: CB-170, CB-089, CB-099, CB-189 & CB-199
- SST-100 & SST-200 - BLACK FINISH
- SST-100-W & SST-200-W - WHITE FINISH
- BEST INSTALLED WITH #6X1/2" (OR LONGER) PAN HEAD SCREW
- VISIT COMPX.COM FOR 3D MODELS

DIMENSIONS ARE IN INCHES TOLERANCES: FRACTIONAL: ±1/32" ANGULAR: ± 3° TWO PLACE DECIMAL: ±.01 THREE PLACE DECIMAL: ±.005 REFERENCE DIMENSIONS: (.XXX)		NAME	DATE	DATE	DRAWING#
DRAWN				DESCRIPTION SLAMSTRIKE CABINET APPLICATIONS	
CHECKED				 	
ENG APPR.					
MFG APPR.					
MATERIAL				715 Center Street Grayslake, IL 60030	
FINISH				Phone: 847-752-2600 Fax: 847-752-2420	
DO NOT SCALE DRAWING					